



Guide

DB Museum

On track for tomorrow.

DB Museum

Maps

Vehicle hall II,
outdoor area

Ground floor

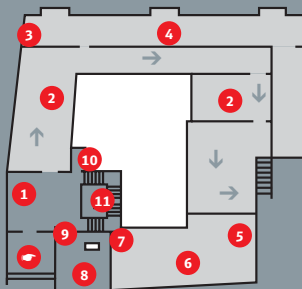

1st floor



2nd floor

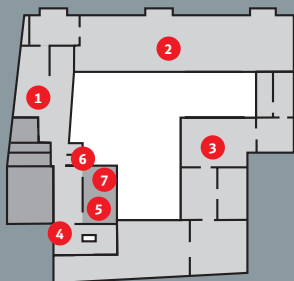

Ground floor

- ➔ Lessingstrasse entrance
- ① Museum Shop
- ② Exhibition: The Beginning of the Railway up to 1945
- ③ Access to Vehicle Hall II and the outdoor area
- ④ Vehicle Hall I
- ⑤ Side entrance and entrance/exit for wheelchair users and visitors with pushchairs
- ⑥ Documentation and Photo Archives
- ⑦ Lockers
- ⑧ Restaurant
- ⑨ Lift
- ⑩ Toilets
- ⑪ Stairs

1st floor

- ① Ballroom
- ② Conference Room I
- ③ The Railway Experience
- ④ Play area with baby-changing room
- ⑤ Model Railway
- ⑥ Exhibition: 1945–1989
- ⑦ History of the Stations
- ⑧ Library
- ⑨ Lift
- ⑩ Toilets
- ⑪ Stairs

2nd floor

- ① Special Exhibitions
- ② Special Exhibitions
- ③ Communications Museum
- ④ Lift
- ⑤ Conference Room II
- ⑥ Toilets
- ⑦ Stairs

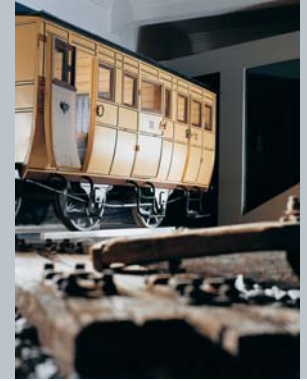

Two Centuries of Railway History

The new DB Museum centres around a large exhibition area dealing with the history of the railway in Germany. Spread over two storeys and an area of 2500 m², the exhibition spans two centuries and explains the interaction of the railway with technology and commerce, politics and culture.

The exhibits range from the early days of the railway in England right through to German reunification in 1989. Visitors experience how the railway revolutionised every aspect of human life in the course of just a few decades in the 19th century and formed the basis for a mobile society. In addition to the success story of the railway as a transport system, however, the exhibition also shows the dark side of its history: the rulers soon recognised the military potential of the railway and in the 20th century, the Reichsbahn formed the logistic backbone of the German war effort and the Holocaust.

But apart from large-scale political considerations, the exhibition also deals with everyday matters such as the gradual progress made in travel comfort and improvements in the working conditions of the railway employees. All the different subjects are featured in absorbing, multimedia presentations. Themed rooms such as the “Adlerama” cinema, the tunnel, waiting rooms and railway compartments make a tour of the exhibition a fascinating voyage of discovery through the different eras of railway history.

“Adlerama” with the original Ludwigsbahn Coach

The “Adlerama” is a small, 50-seat cinema with panorama screen in which DB Museum has installed a memorial to the first German steam-powered railway, which ran from Nuremberg to Fürth in 1835. In this special viewing room, a high-tech film transports visitors back to the time around 1835. As they travel on the Adler engine on a summer’s day, railway founders Georg Zacharias Platner, Johannes Scharrer and train driver William Wilson reminisce about how their historic work was accomplished.

Beside the “Adlerama”, DB Museum has reserved a place of honour for the oldest passenger coach still in existence in Germany: the exhibition organisers have brought the only remaining original Ludwigsbahn coach out from the shadow of the famous “Adler” replica and placed it on a fitting pedestal.



Deutsche Reichsbahn during the Nazi Regime

The DB Museum dedicates a special section of the permanent exhibition to the role of Deutsche Reichsbahn during the Nazi regime, showing how the staff and organisation of Deutsche Reichsbahn were used to achieve the objectives of the National Socialists. Previously unpublished photos, original documents and exhibits illustrate the history of Deutsche Reichsbahn from 'gleichschaltung', i.e. gradually bringing it into line with the Nazi ideology, right through to its culpable involvement in the Nazi crimes.

The focal point of this section is the documentation of the deportation of millions of people to the extermination camps. In accordance with the solemnity of the topic, the presentation is subdued. The photos, documents and in particular the film recordings of reports by contemporary witnesses – former forced labourers and survivors of the Holocaust – speak for themselves.

Goggo versus Railbus

The 1950s saw the emergence of some peculiar road vehicles which made life difficult for the railways. Miniature motor vehicles, which were really more like covered mopeds than cars, poached hundreds of thousands of loyal customers away from the railway. The most successful of these small cars was the Goggomobil, produced by Glas in Dingolfing.



In the exhibition, a scarlet sports version is displayed opposite an original railbus, an inexpensive rail vehicle introduced by the German railway in an attempt to win back market shares, especially in rural areas. The railbus was therefore sometimes referred to as the “saviour of the small railways”.

Waiting Room for “Persons of the Highest Rank”

The crowned heads of the 19th century had separate waiting rooms reserved exclusively for themselves and other “persons of the highest rank” at the major railway stations. These rooms were magnificently appointed and bore the insignia of their royal patrons. However, they were rarely used, as even in the 19th century, rulers had little time for waiting. Most of these rooms vanished on the abolition of the monarchy in Germany.

The Royal Salon from Nuremberg Central Station, which was demolished in 1902, has survived at DB Museum: designed by Friedrich Bürklein in 1863, this room with its intricate neo-Gothic wood carvings is a typical example of the splendid pomp that surrounded the monarchy during the industrial age.



Vintage Vehicles at the DB Museum

The two vehicle halls at DB Museum show more than 25 vintage railway vehicles, ranging from a replica of “Adler” steam engine to the legendary E 03 electric locomotive.

Vehicle Hall I features rail legends from the 19th century, including the oldest German locomotive that still exists today, the Bavarian express locomotive S 2/6 from 1853, and a replica of the “Adler”, the locomotive of the first German railway.

The royal train of Bavaria’s fairy-tale King Ludwig II and the saloon coach of Chancellor Bismarck are strikingly presented at the “royal platform”.

The 20th-century exhibits in Vehicle Hall II include a 05 001, one of the fastest steam engines in the world.

The outdoor area is open all year round and shows a historic signalbox building, a railway platform as well as other railway vehicles. Trips on a narrow-gauge railway are available on Saturdays and Sundays.



The Hands-On Experience

This “hands-on museum” features an entertaining presentation of railway history and railway operations and is fascinating especially for youngsters, who have the opportunity to operate original signals and switches, or to assume the role of level-crossing attendant and open up the barriers for other visitors.

The engine simulator is a thrilling experience for would-be train drivers: the simulation programme is integrated in an original driver’s cab in a Class 111 electric locomotive. After a break of ten years, visitors can again enjoy original film clips from the 1950s, seen from the train driver’s perspective.

At the touch of a button, visitors can embark on a trip through the history of the railway from 1855 to 1985. Five small model railway landscapes show the changes in railway, cityscape and countryside over the years.

A 1:87 scale model of today’s railway operations is displayed on a large model railway with a track length of 500 metres. More than 30 trains are sent on their way during the demonstration. The “duty traffic controller” manages the train operations from an original track diagram control panel. Demonstrations: every hour from 9:30 h to 16:30 h, and from 10:30 h to 17:30 h on Saturdays and Sundays.



Library

The DB Museum public library houses the most important collection of railway literature in Germany. For more than 100 years, the library has collected magazines and books dealing with all aspects of the railway and related subjects. The entire collection is computer indexed and currently consists of more than 40,000 volumes, dating from the 18th century to the present day.

Visitors can use the library subject to prior arrangement during the following opening hours: Tue to Fri from 13:00 to 17:00 h. To make an appointment please call the service centre, + 49 (0) 180 4 442233, during office hours between 9:00 h and 13:00 h.

(20 cents per call for German landline calls, mobile phone charges max. 42 cents per call).

Documentation and Photo Archives

The documentation and photo archives contain a large number of highly diverse documents, photographs and films from two centuries of railway history. All items are computer indexed. The archives cover some 2500 metres of shelf space and include more than one million photos, ranging from the files of Ludwigs-Eisenbahngesellschaft railway company, which ushered in the railway era in Germany in 1835, to operating manuals for locomotives, technical drawings of railway vehicles and installations, to statistics and financial reports of various railway companies, right through to a



collection of graphics and posters consisting of approx. 70,000 individual items.

The photographs, the oldest of which date back to the 19th century, are available as prints, glass slides and negatives. The collection can be used by prior arrangement during the following opening hours: Tue to Thu from 9:00 to 12:00 h and 13:00 to 16:00 h. To make an appointment please call the service centre, + 49 (0) 180 4 442233, during office hours between 9:00 h and 13:00 h.

(20 cents per call for German landline calls, mobile phone charges max. 42 cents per call).

Railway Literature and Souvenirs – to refresh your own memory or give to others.

To ensure that you retain fond memories of your day at the DB Museum for a long time to come, the museum shop stocks all kinds of railway articles: stylish accessories, gifts for your loved ones back home, and an excellent selection of high-class railway literature. Take a few minutes to browse around and see what is available. We look forward to seeing you in the museum shop in the entrance hall, open throughout the regular museum opening hours.

Audio Guide

The portable audio player offers tours of the permanent exhibition in German, English, French and Italian. The audio guide is available at the ticket desk.

Functions at the DB Museum



Conferences and Private Functions at the DB Museum

Whether a conference, concert, wedding or birthday party – the DB Museum has a choice of various rooms in a unique setting to suit your individual requirements, ranging from a compact conference room to a prestigious, large ballroom.

The Vehicle Hall can hold up to 200 for stand-up receptions, the Ballroom up to 196 and Conference Room I up to 40 guests.

To order our brochure “Feiern und Tagen im DB Museum” (Conferences and Private Functions at the DB Museum, German only) please call + 49 (0) 911 219-4620. You can also make a booking under the same number.

Food and Drink

There is no need to do without your creature comforts when you visit the DB Museum. “Lessing” restaurant offers everything from a small snack to a three-course meal – whatever you choose – in a pleasant atmosphere.
Tel.: + 49 (0) 170 5427374.

DB Museum Branches

DB Museum Koblenz

The museum is located in the former freight repair depot at Koblenz-Lützel and has a collection of more than 40 vintage vehicles (electric locomotives, saloon and passenger coaches). The permanent exhibition shows the history of electric traction. The large loco shed can be hired for events of all kinds.

Opening hours:

22. January – 10. December 2011

Every Saturday from 10:00 to 16:00 h

Admission charges:

Adults EUR 2.50, concessions EUR 2, children EUR 1, families EUR 5

Address:

DB Mobility Logistics AG
DB Museum Koblenz, Schönbornluster Strasse 3,
56070 Koblenz, Tel.: +49 (0) 261 396-1339,
E-Mail: wolfgang.ihrlich@deutschebahn.com

DB Museum Halle (Saale)

In 1863, Halle depot went into operation as a repair shop for railway vehicles on the site of the present DB Museum. The locomotive shed was built in 1895; this was where the Vehicle Test Centre (FVA), later renamed VES-M, was established in 1952 and this is where the DB Museum is now located.

Visitors to the museum can see former test vehicles and prototypes of Deutsche Reichsbahn, including steam locomotive 03 1010 and electric locomotive E 18 31. The loco shed can also be hired for events of all kinds.

Opening hours:

6. February – 10. December 2011

Every Saturday from 9:00 to 14:00 h

Admission charges:

Adults EUR 2.50, concessions EUR 2, children EUR 1, families EUR 5

Address:

DB Mobility Logistics AG
DB Museum Halle (Saale), Lokhalle IV Bw Halle P,
Berliner Strasse 240, 06112 Halle (Saale),
Tel.: +49 (0) 345 560-3545, E-Mail: lokschuppen4@web.de

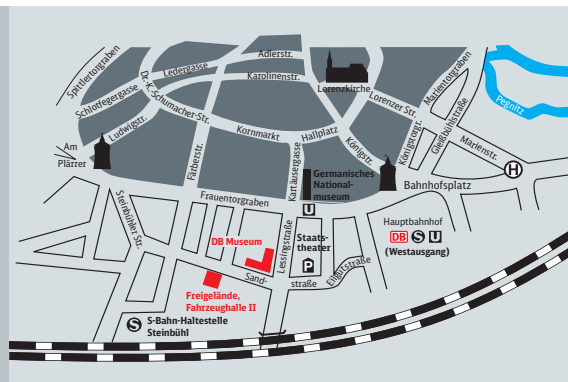

Journey of Discovery around the Museum

The museum's educational department has something to offer all age groups, from pre-school kids right through to adults. A young team of expert guides invite you to join them on a fascinating journey of discovery around the museum.

Children

The guides have special material boxes containing lots of surprises for children's birthday parties and family outings.

School Groups

Teachers are invited to move the history lesson to the museum, as many exhibits and subjects are closely linked with the school curriculum, e.g. "Railway and Industrialisation" and "Deutsche Reichsbahn during the Nazi Regime".

Adults

A guided tour gives adults on their first visit the chance to gain an overall idea of the museum or connoisseurs the opportunity to take an in-depth look at special subjects.

For details of further offers, please contact

+ 49 (0) 180 4 442233*

info@db-museum.de or www.dbmuseum.de

Please consult our brochure "Führungen durch das DB Museum Nürnberg" (Guided Tours of DB Museum Nuremberg, German only), which is available at the ticket desk.

* (20 cents per call for German landline calls, mobile phone charges max. 42 cents per call).

Opening Hours:

Tuesday to Sunday 9:00 to 17:00 h, Saturday and Sunday 10:00 to 18:00 h, closed on Mondays. Also open on Easter Monday, Whit Monday, Mondays in Advent, Monday during the Nuremberg Toy Fair. Closed on 1 January, Good Friday, 1 May, 24, 25 and 31 December. The outdoor area is generally open at all times and is closed only if the ground is in poor condition.

Admission Charges

	EUR
Adults	5.00
Concessions*	4.00
Children (6 – 17)	2.50
School classes (per pupil)*	2.00
Families (2 adults and up to 4 children)	10.00
Personal Annual Ticket	EUR
Adults	15.00
Concessions*	12.00
Children (6 – 17)	7.50
Families (2 adults and up to 4 children)	25.00

* DB/VGN (date-cancelled ticket showing the date of the visit to the DB Museum or personal DB Netzkarte which is valid on the date of the visit), groups of 10 or more, per person senior citizens/students/disabled/persons doing military service or alternative community service, employees of DB/BSW/Post and Telekom, members of RocoClub, Märklin Insider, DGPT

www.dbmuseum.de – the DB Museum at a Glance

To obtain a comprehensive overview of the museum, visit our website at www.dbmuseum.de.

Contact

DB Mobility Logistics AG
DB Museum
Lessingstrasse 6
90443 Nürnberg

Subject to change without notice.

No liability accepted for the
accuracy of the details given.

Information correct at: March 2011

www.dbmuseum.de